

DIMENSIONS

- A 1.43
- B 1.6
- C .59
- D .62

- F 1" NPT THREAD *
- G 1 3/8"-16 THREAD *
- "GO" P.D.= 1.3300"
- "NO GO" P.D.= 1.3250"
- * RUN TH'D TO FREE FIT

* MACHINE BENEATH HEX TO ACHIEVE LENGTH "D"

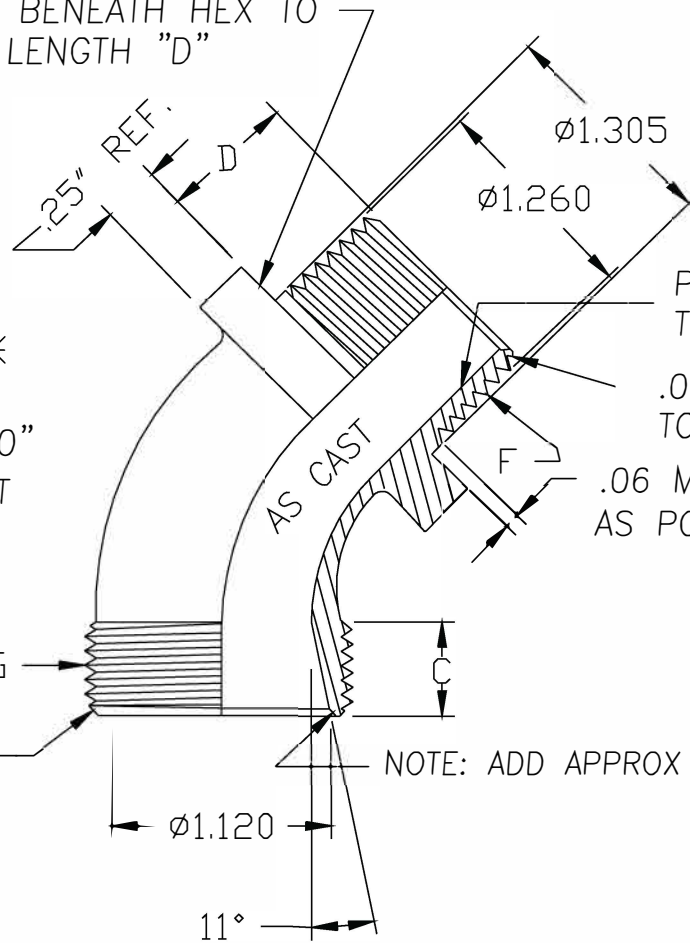

PARTIAL CLEAN-UP PERMISSIBLE TO ELIMINATE FLASH (BOTH ENDS)

.03 X 45° APPROX. AND FACE OFF FIRST TO ELIMINATE FLASH

.06 MAX.—MACHINE THREAD AS CLOSE AS POSSIBLE BENEATH HEX *

* .03 X 45° APPROX. FACE OFF FIRST TO ELIMINATE FLASH

NOTE: ADD APPROX 1/64 I.D. CHAMFER ON BOTH ENDS

* CRITICAL DIMENSIONS



REV.	DATE	CHANGE
A	7-2-99	REDRAWN USING CAD
B	8/16/06	REDRAWN & REDIMENSIONED
C	8/12/10	DIM. ".26" HEX THICKNESS IS NOW .25' REF. AND ADDED BOLD NOTES FOR CLARIFICATION.
		AND ELIMINATED DIM. "E" 1.03 X .81 DP. CV

UNLESS OTHERWISE SPECIFIED
 3-PLC. DIM. +/-.005
 2-PLC. DIM. +/-.010
 1-PLC. DIM. +/-.015
 FRACTIONAL +/1/64
 ANGULAR +/°1

SCALE: APPROX FULL
 MATERIAL: ALUM SAND CAST
 FINISH: NATURAL
 PART NAME: 45 DEGREE BODY
 PART NUMBER: RSR-45300-B
 DRAWING DATE: 920212